

TEXMO[®]

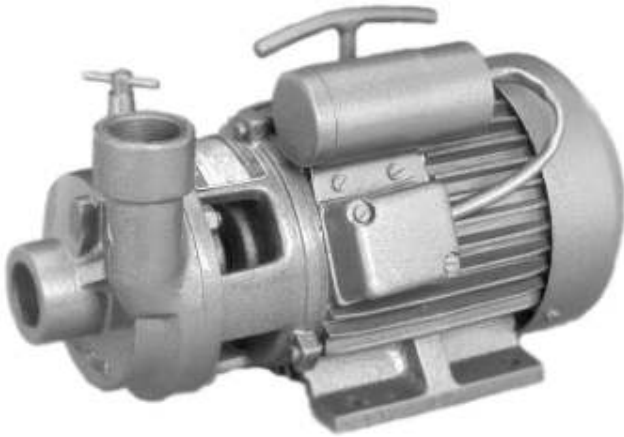

SINGLE PHASE CGH MONOBLOCK



INSTALLATION & SPARE PARTS MANUAL

MANUFACTURED BY:

AQUASUB ENGINEERING UNIT-II

S.F. No. 308, Vethalaikali Palayam,
N.S.N. Palayam Post,
Coimbatore - 641 031.

TEXMO SINGLE PHASE

CGH MONOBLOCK

INSTALLATION :

The TEXMO Single Phase CGH Monoblock Pumpsets are extremely easy to install, ruggedly built and designed for many years of trouble free operation. It should be installed in a place relatively free from dust, fumes and moisture. The vertical distance between the water level at the suction side and the pump should not exceed 26 feet (8 meters). The Monoblock should be connected to a single phase 50 cycles A.C. supply with voltage ranging from 200-240 Volts. The supply leads are to be connected to the Monoblock terminals marked A1 & A2. The Monoblock should be properly Earthed.

PRECAUTIONS :

- 1) A good quality foot valve should be used to avoid priming problems, since the pump is not self-priming.
- 2) Wire size should be sufficient. Use 3/20 wire.
- 3) Only recommended pipe size should be used. Small pipe sizes, nipples, elbows, bends all give rise to pressure losses and should either be eliminated or used sparingly.
- 4) Do not wrap the motor with airtight materials such as polythene sheet. Cooling will not be there and motor will burnout.
- 5) Bearing require no lubrication for 3 years under normal conditions. When regreasing only half the space between bearing and cap should be filled with grease.

6. The Monoblock should be run for a few minutes once in every 3 days to prevent the pump from seizing due to rust build up.
7. Do not throttle the delivery line using a gate valve as this will result in over loading the motor.

SPARES :

While ordering for spares, the complete name plate details of the monoblock with the required Part No. (as per the part list) are to be specified clearly.

SPARE PARTS LIST :

Part Number	Part Name	Quantity	Material
2	Shaft With Rotor	1	Alloy Steel
3	Front Bearing	1	
4	Front Inner cap	1	Cast Iron
5	Motor Frame	1	Cast Iron
6	Capacitor	1	
7	Rear Inner Cap	1	Mild steel
8	Rear Bearing	1	
9	Back Cover	1	Cast Iron
10	Terminal Box	1	Plastic
11	Terminal Board	1	Bakelite
12	Cooling Fan	1	Plastic

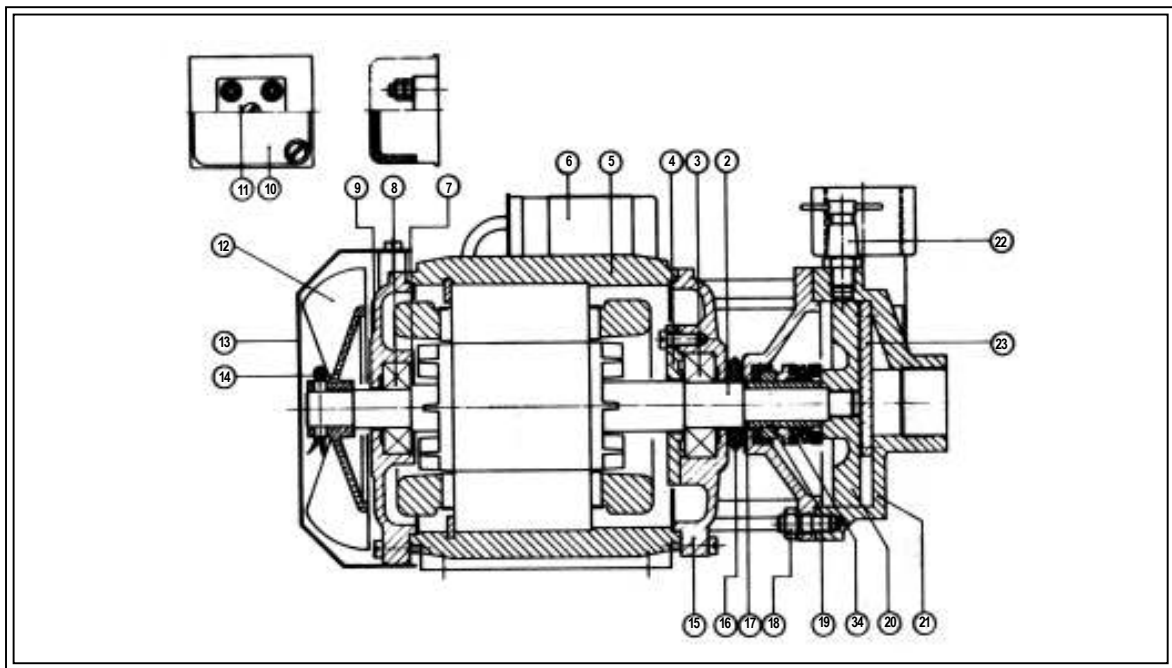

CROSS-SECTIONAL VIEW OF CGH MONOBLOCK WITH PART NUMBERS